

Atomizzatori idraulici a cono semi vuoto

Hollow cone hydraulic atomizing fine spray nozzles

6MA - 1/8" P - RNP

Installazioni tipiche - Typical installations

Schema d'installazione - Installation layout

Ugello montato con fascetta
Nozzle mounted with split-eyelet



Ugello montato con adattatore
Nozzle mounted with adapter

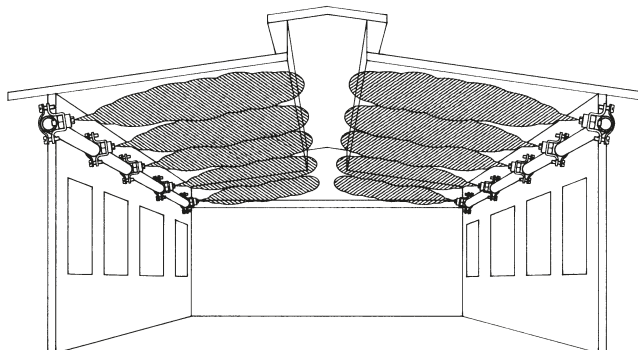

Per ordinare - To order

Ugelli completi, specificare: - Complete nozzles, please specify:

1/8"	P	0,24	BR	=	1/8P0,24BR
Attacco Pipe connection	Tipo Type	Codice Code	Materiale* Material*		Esempio Example

Solo punte di spruzzo, specificare: - For only tips, please specify:

RNP	0,20	BR	=	RNP0,20BR
Tipo Type	Codice Code	Materiale* Material*		Esempio Example

* Vedi Pag. 3 - See page 3 for list

Dimensioni max ingombro - Max dimensions

Attacco Pipe connection	Ugello tipo - Nozzle type							
	6MA		1/8" P		RNP		RRNP	
	A mm	B mm	A mm	B mm	A mm	B mm	A mm	B mm
6MA	10	10 hex						
1/8"			13	11 hex	48	21 hex	48	21 hex
1/4"					48	21 hex	48	21 hex
3/8"					48	22 hex	48	21 hex
1/2"					48	25 hex	48	22 hex

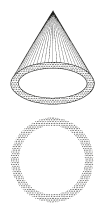

Ugelli a cono vuoto in polipropilene

Polypropylene hollow cone spray nozzles

CXP

CARATTERISTICHE DI SPRUZZO

Getto a cono vuoto con distribuzione uniforme, buona nebulizzazione a tutte le pressioni e proiezione ad angolo retto.

COSTRUZIONE

Realizzati in due pezzi con testa di spruzzo intercambiabile e passaggi completamente liberi per ridurre al minimo eventuali problemi di intasamento. Esistono anche con testine di spruzzo ad angolo ampio con caratteristiche tecniche identiche al CW illustrate a pag. 40-41. Gli ugelli CXP hanno un attacco femmina da 3/8" con filettatura Gas cilindrica (BSPP - UNI 338).

MATERIALI STANDARD

Polipropilene caricato con fibre di vetro.

APPLICAZIONI TIPICHE

Trattamento delle superfici dei metalli, processi chimici, sgrassatura prodotti, raffreddamento per evaporazione nelle torri, ecc.

SPRAY CHARACTERISTICS

This provides a hollow cone spray pattern with coverage uniformity over the entire ring-like surface as well as a good atomizing effect at all pressures. The sprayed fluid creates a right angle projection with the inlet axis.

CONSTRUCTION

It is a two-piece moulded unit with interchangeable tips and its completely free passage reduces clogging problems to the minimum. They have their own appropriate wide angle tips which have the same characteristics as those of the CW series shown on the chart. (See page 40-41). All the CXP are exclusively available with Gas parallel threading (BSPP - UNI 338) 3/8" female pipe connection.

STANDARD MATERIALS

Fibreglass re-inforced polypropylene.

TYPICAL APPLICATIONS

Metal surface treatment, chemical processes, product degreasing, evaporative cooling in cooling towers, etc.

Tipo - Type

CXP

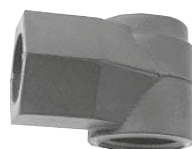
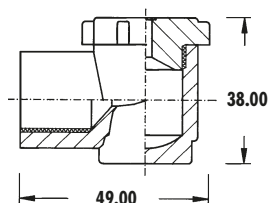

Ugelli a cono vuoto in polipropilene

Polypropylene hollow cone spray nozzles

CXP



Tabella delle portate – Capacity chart

Ugello - Nozzle			Diametro Ingresso Ø Inlet mm	Orifizio Orifice Ø Nom. mm	Pressione - Pressure (Bar)												Angolo di spruzzo Spray angle			
Attacco femmina Female connect.	Tipo Type	Codice Code			0,2	0,5	1	1,5	2	2,5	3	4	5	6	7	8	10	0,5 Bar	1,5 Bar	6 Bar
					Portata - Capacity (l/min)															
3/8"	CXP	5 - 5	3,57	3,18	1,01	1,60	2,26	2,76	3,19	3,57	3,91	4,51	5,05	5,53	5,97	6,38	7,14	55°	66°	81°
		5 - 8	3,57	4,37	1,21	1,92	2,71	3,32	3,83	4,28	4,69	5,42	6,06	6,63	7,17	7,66	8,56	60°	71°	86°
		5 - 10	3,57	4,76	1,35	2,14	3,02	3,70	4,28	4,78	5,24	6,05	6,76	7,41	8,00	8,55	9,56	70°	80°	90°
		5 - 15	3,57	5,95	1,61	2,55	3,61	4,42	5,11	5,71	6,25	7,22	8,07	8,85	9,55	10,21	11,42	75°	84°	94°
		5 - 20	3,57	6,35	1,74	2,74	3,88	4,75	5,49	6,14	6,72	7,76	8,68	9,51	10,27	10,98	12,28	87°	93°	99°
		5 - 25	3,57	7,54	1,92	3,03	4,29	5,25	6,06	6,78	7,43	8,58	9,59	10,50	11,35	12,13	13,56	90°	95°	101°
		5 - 40	3,57	9,13	2,22	3,51	4,97	6,08	7,02	7,85	8,60	9,93	11,10	12,16	13,14	14,04	15,70	98°	106°	109°
		8 - 5	4,37	3,18	1,21	1,92	2,71	3,32	3,83	4,28	4,69	5,42	6,06	6,63	7,17	7,66	8,56	53°	60°	68°
		8 - 8	4,37	4,37	1,61	2,55	3,61	4,42	5,11	5,71	6,25	7,22	8,07	8,85	9,55	10,21	11,42	59°	69°	75°
		8 - 15	4,37	5,95	2,22	3,51	4,97	6,08	7,02	7,85	8,60	9,93	11,10	12,16	13,14	14,04	15,70	70°	80°	87°
		8 - 20	4,37	6,35	2,42	3,83	5,42	6,63	7,66	8,56	9,38	10,83	12,11	13,27	14,33	15,32	17,13	80°	85°	90°
		8 - 25	4,37	7,54	2,62	4,15	5,87	7,19	8,30	9,28	10,16	11,74	13,12	14,37	15,53	16,60	18,56	82°	89°	93°
		8 - 40	4,37	9,13	3,23	5,11	7,22	8,85	10,21	11,42	12,51	14,44	16,15	17,69	19,11	20,43	22,84	87°	95°	99°
		8 - 60	4,37	13,10	4,04	6,38	9,03	11,06	12,77	14,27	15,64	18,06	20,19	22,11	23,89	25,53	28,55	97°	107°	111°
		10 - 5	5,16	3,18	1,31	2,07	2,93	3,59	4,15	4,64	5,08	5,87	6,56	7,19	7,76	8,30	9,28	51°	58°	65°
		10 - 8	5,16	4,37	1,74	2,74	3,88	4,75	5,49	6,14	6,72	7,76	8,68	9,51	10,27	10,98	12,28	58°	68°	72°
		10 - 10	5,16	4,76	2,02	3,19	4,51	5,53	6,38	7,14	7,82	9,03	10,09	11,06	11,94	12,77	14,27	62°	69°	77°
		10 - 15	5,16	5,95	2,42	3,83	5,42	6,63	7,66	8,56	9,38	10,83	12,11	13,27	14,33	15,32	17,13	69°	79°	83°
		10 - 20	5,16	6,35	2,83	4,47	6,32	7,74	8,94	9,99	10,95	12,64	14,13	15,48	16,72	17,87	19,98	74°	81°	85°
		10 - 25	5,16	7,54	3,03	4,79	6,77	8,29	9,58	10,71	11,73	13,54	15,14	16,59	17,91	19,15	21,41	78°	87°	92°
		10 - 40	5,16	9,13	3,84	6,06	8,58	10,50	12,13	13,56	14,85	17,15	19,18	21,01	22,69	24,26	27,12	85°	94°	98°
		10 - 50	5,16	11,11	4,44	7,02	9,93	12,16	14,04	15,70	17,20	19,86	22,21	24,33	26,27	28,09	31,40	93°	102°	107°
		10 - 60	5,16	13,10	5,05	7,98	11,28	13,82	15,96	17,84	19,55	22,57	25,23	27,64	29,86	31,92	35,69	95°	105°	109°
		15 - 5	5,95	3,18	1,53	2,43	3,43	4,20	4,85	5,42	5,94	6,86	7,67	8,40	9,08	9,70	10,85	40°	47°	59°
		15 - 8	5,95	4,37	2,02	3,19	4,51	5,53	6,38	7,14	7,82	9,03	10,09	11,06	11,94	12,77	14,27	50°	58°	64°
		15 - 10	5,95	4,76	2,42	3,83	5,42	6,63	7,66	8,56	9,38	10,83	12,11	13,27	14,33	15,32	17,13	52°	60°	67°
		15 - 15	5,95	5,95	3,03	4,79	6,77	8,29	9,58	10,71	11,73	13,54	15,14	16,59	17,91	19,15	21,41	60°	68°	72°
		15 - 20	5,95	6,35	3,43	5,43	7,67	9,40	10,85	12,13	13,29	15,35	17,16	18,80	20,30	21,70	24,27	64°	70°	75°
		15 - 25	5,95	7,54	4,04	6,38	9,03	11,06	12,77	14,27	15,64	18,06	20,19	22,11	23,89	25,53	28,55	66°	74°	78°
		15 - 40	5,95	9,13	5,05	7,98	11,28	13,82	15,96	17,84	19,55	22,57	25,23	27,64	29,86	31,92	35,69	81°	84°	87°
		15 - 50	5,95	11,11	6,06	9,58	13,54	16,59	19,15	21,41	23,46	27,08	30,28	33,17	35,83	38,30	42,82	84°	91°	98°
		15 - 60	5,95	13,10	7,07	11,17	15,80	19,35	22,34	24,98	27,36	31,60	35,33	38,70	41,80	44,69	49,96	90°	97°	102°
		20 - 5	7,14	3,18	1,68	2,65	3,75	4,59	5,30	5,92	6,49	7,49	8,38	9,18	9,91	10,60	11,85	35°	40°	55°
		20 - 10	7,14	4,76	2,83	4,47	6,32	7,74	8,94	9,99	10,95	12,64	14,13	15,48	16,72	17,87	19,98	39°	55°	65°
		20 - 15	7,14	5,95	3,63	5,75	8,13	9,95	11,49	12,85	14,07	16,25	18,17	19,90	21,50	22,98	25,69	55°	63°	68°
		20 - 20	7,14	6,35	4,04	6,38	9,03	11,06	12,77	14,27	15,64	18,06	20,19	22,11	23,89	25,53	28,55	59°	66°	70°
		20 - 25	7,14	7,54	5,05	7,98	11,28	13,82	15,96	17,84	19,55	22,57	25,23	27,64	29,86	31,92	35,69	65°	73°	77°
		20 - 40	7,14	9,13	5,85	9,26	13,09	16,03	18,51	20,70	22,67	26,18	29,27	32,06	34,63	37,03	41,40	80°	82°	86°
		20 - 50	7,14	11,11	7,07	11,17	15,80	19,35	22,34	24,98	27,36	31,60	35,33	38,70	41,80	44,69	49,96	83°	90°	97°
		25 - 10	7,54	4,76	3,03	4,79	6,77	8,29	9,58	10,71	11,73	13,54	15,14	16,59	17,91	19,15	21,41	35°	50°	59°
25 - 20	7,54	6,35	4,44	7,02	9,93	12,16	14,04	15,70	17,20	19,86	22,21	24,33	26,27	28,09	31,40	53°	63°	68°		
25 - 25	7,54	7,54	5,05	7,98	11,28	13,82	15,96	17,84	19,55	22,57	25,23	27,64	29,86	31,92	35,69	60°	70°	74°		
25 - 40	7,54	9,13	6,46	10,21	14,44	17,69	20,43	22,84	25,02	28,89	32,30	35,38	38,22	40,86	45,68	69°	73°	79°		
25 - 60	7,54	13,10	9,08	14,36	20,31	24,88	28,73	32,12	35,18	40,63	45,42	49,76	53,74	57,45	64,23	83°	89°	92°		
40 - 8	9,53	4,37	3,03	4,79	6,77	8,29	9,58	10,71	11,73	13,54	15,14	16,59	17,91	19,15	21,41	20°	41°	48°		
40 - 10	9,53	4,76	3,63	5,75	8,13	9,95	11,49	12,85	14,07	16,25	18,17	19,90	21,50	22,98	25,69	23°	45°	53°		
40 - 15	9,53	5,95	4,84	7,66	10,83	13,27	15,32	17,13	18,76	21,67	24,22	26,54	28,66	30,64	34,26	34°	48°	57°		
40 - 20	9,53	6,35	5,45	8,62	12,19	14,93	17,24	19,27	21,11	24,38	27,25	29,85	32,25	34,47	38,54	42°	52°	59°		
40 - 25	9,53	7,54	6,46	10,21	14,44	17,69	20,43	22,84	25,02	28,89	32,30	35,38	38,22	40,86	45,68	48°	56°	61°		
40 - 40	9,53	9,13	8,07	12,77	18,06	22,11	25,53	28,55	31,27	36,11	40,37	44,23	47,77	51,07	57,10	67°	71°	73°		
40 - 50	9,53	11,11	10,09	15,96	22,57	27,64	31,92	35,69	39,09	45,14	50,47	55,28	59,71	63,84	71,37	68°	80°	84°		
40 - 60	9,53	13,10	12,11	19,15	27,08	33,17	38,30	42,82	46,91	54,17	60,56	66,34	71,66	76,60	85,65	80°	86°	90°		

Installazione tipica - Typical installation

Per ordinare - To order

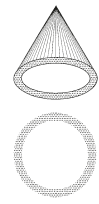
Specificare - Specify:

3/8"	CXP	15-20	MOP	=	3/8CXP15-20MOP
Attacco Pipe connection	Tipo Type	Codice Code	Materiale* Material*		Esempio Example

* Vedi Pag. 3 - See page 3 for list

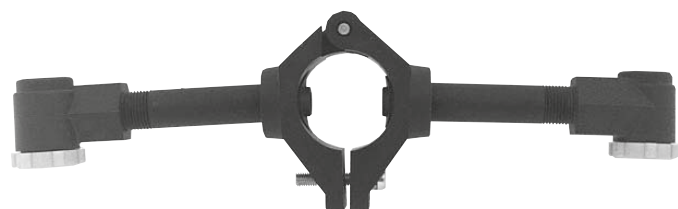

Fascetta tipo - HPG - Split-eyelet